

Instruction Manual - SmartControl Interface



Smart heating-
- Save energy



<https://ttiapp.technotherm.com>



This is a quick reference guide.
More detailed information, vi-
deos and error messages can be
found on the following website:

www.electric-smart-heater.com

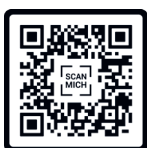

SCAN ME

Link to the web page

THESE INSTRUCTIONS SHOULD BE READ CAREFULLY AND
RETAINED FOR FUTURE REFERENCE.
BE SURE TO OBSERVE ALL LABELS AND WARNINGS ON
THE APPLIANCE.

Edition:06/22
Nr.: MAG-000 146

Subject to errors and technical amendments. Dimensions without guarantee!

1.0 Operating the devices via an app

1.1 First steps

- a) Download the app or go to the following website:
<https://ttiapp.technotherm.com>
Follow the further instructions
- b) You can find a detailed video tutorial of the app at www.electric-smart-heater.com

Download der APP:



SCAN ME

2.0 Operation of the devices without app

2.1 Modus

The radiator can work at 3 different modes:

- **Auto.** The setting temperature varies automatically following the programmed Schedule, based on the 3 custom temperatures. The bars in the LCD display inform about which of the 3 temperatures is assigned to each hour. This mode can be disabled in advanced settings so the radiator can work only in 2 modes (Manual and Off)
- **Manual.** Fixed temperature. The set temperature only changes if the user modifies it.
- **Off.** The radiator does not heat, but can receive remote orders



SCAN ME

In „Auto“ mode -when the temperature is changed in time, the change is effective for the next 1h30 min. In „Manual“ mode, the set temperature is fixed.

2.2 Adjust programmed temperatures

In "Auto" mode the temperature of each hour will change automatically following the programmed Schedule. The user must assign one of the temperatures to each hour:

- Comfort (☀), used normally when the user is at home.
- Eco or saving (☾), für kurze Abwesenheitsperioden
- Freeze (❄), used for periods of absence.

Set the 3 temperatures

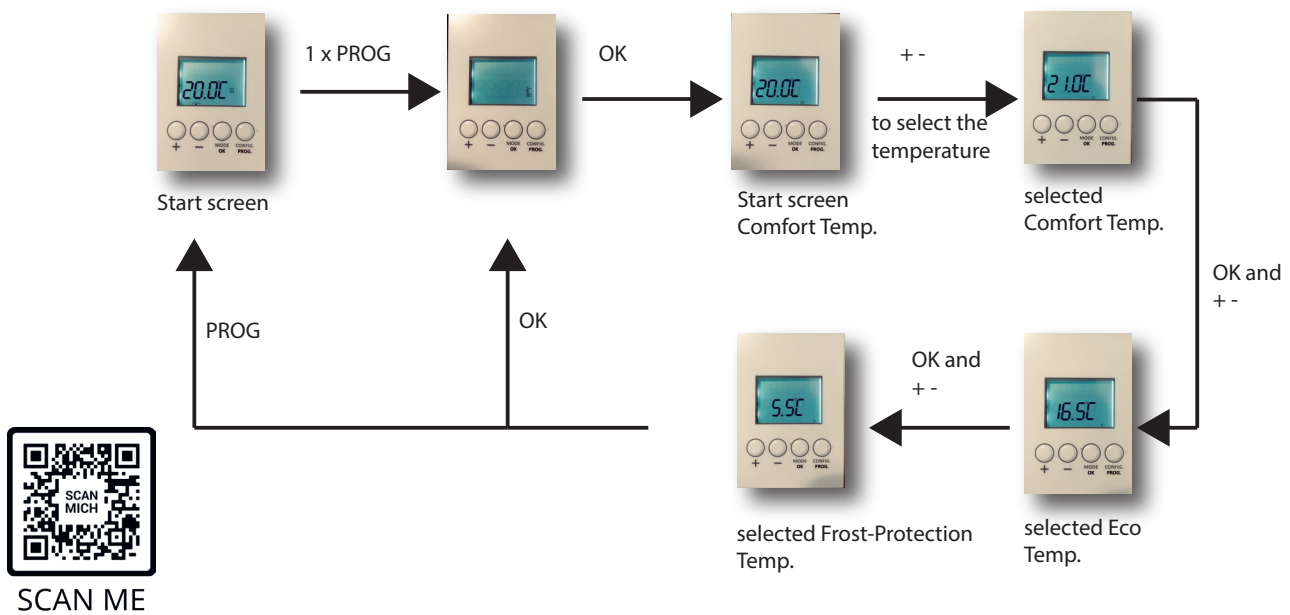

2.3 Programming the time and day

Programming the Day and Time

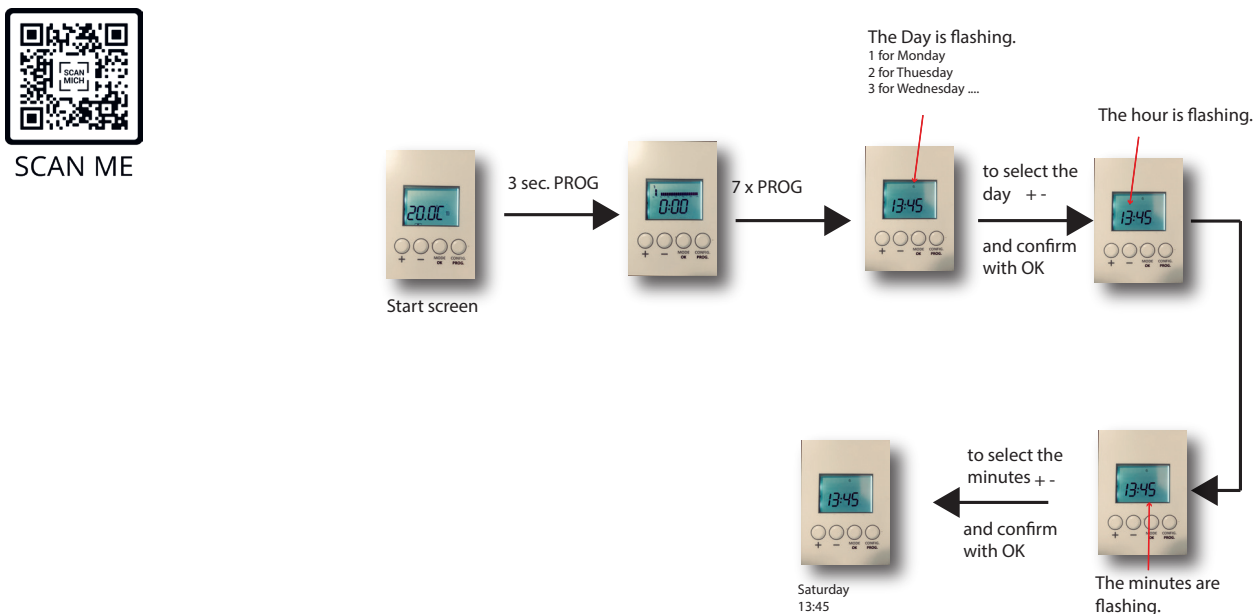

2.4 Screen lock



SCAN ME

lock / unlock the LCD screen

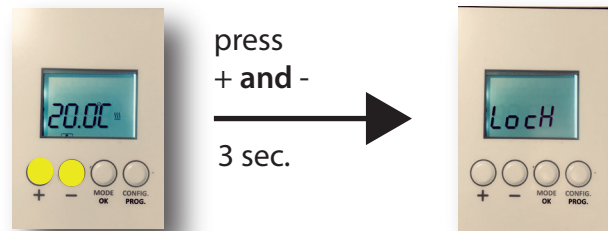

Start screen

2.5 Reset

Reset the device

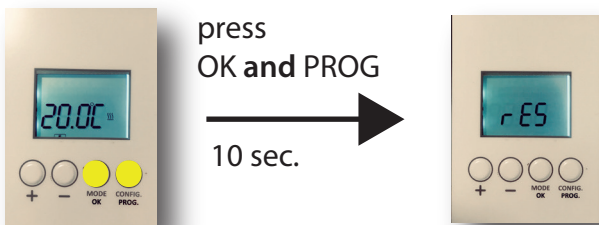

Start screen

Smartbox reset

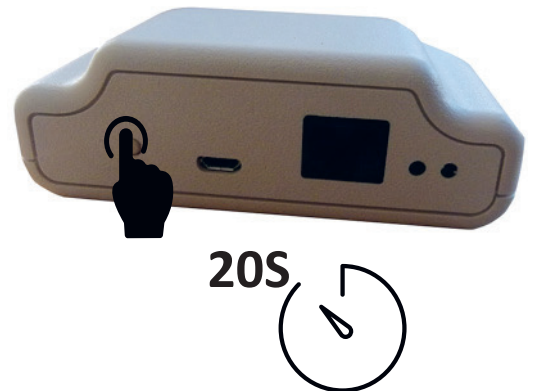

2.6 Programming of weekly and daily temperatures

The heater allows you to create a weekly program that assigns one of the 3 available temperatures to each hour. The program for each day can be different.

- Use **comfort temperature** for the hours you are at home (represented by 2 rows of bars on the display).
- Use the **ECO temperature** for the times when you are away from home (represented by 1 row of bars on the display).
- Use **frost protection** when you are away from home for long periods of time (represented by no bar row on the screen).

Example:

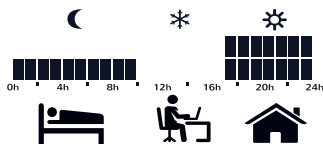

Weekday programming.

To use weekday programming the comfort, eco and frost protection temperatures have to be programmed before. See chapter 10.2

e.g. Day 1:

Eco from 00.00 till 6:00.

Comfort from 6:00 till 21:00

Frost protection from 22:00 till 24:00

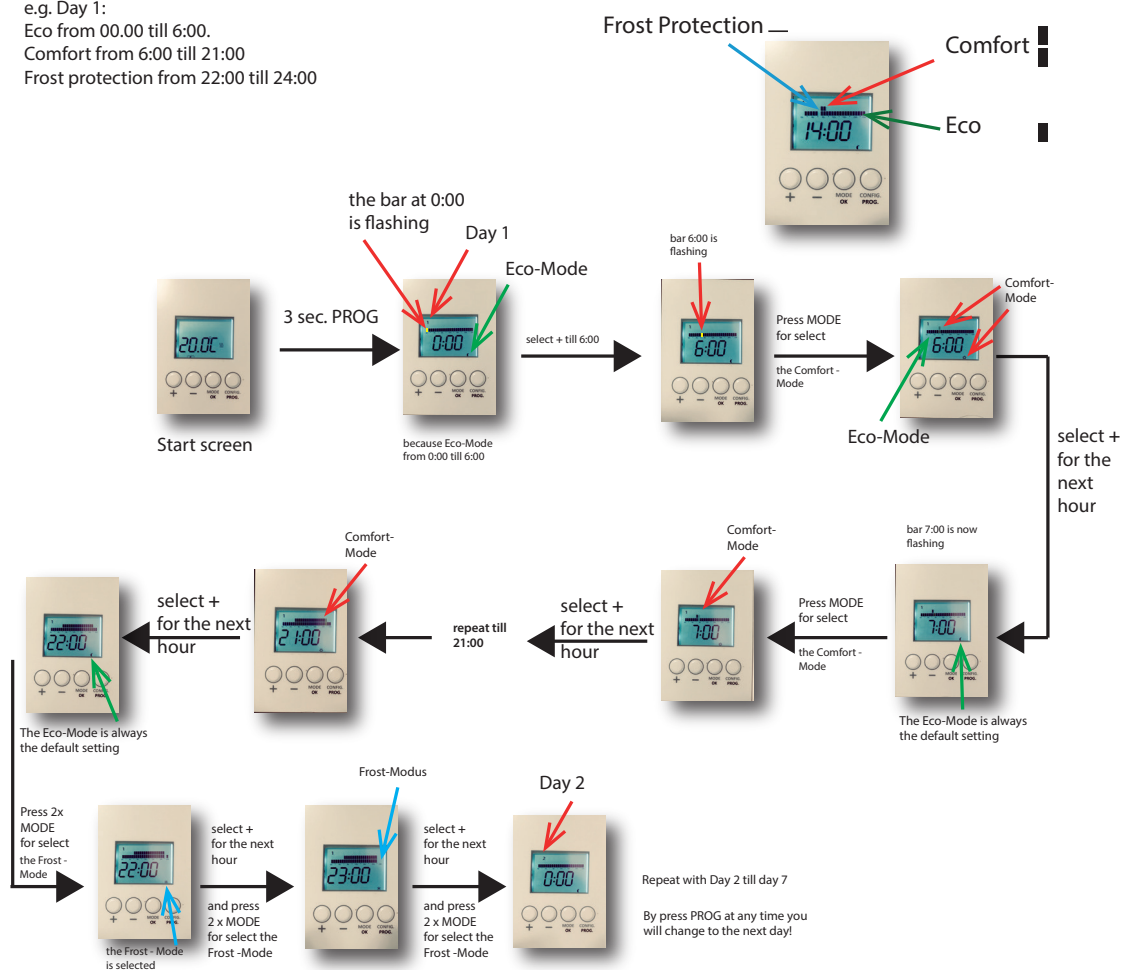

SCAN ME

2.7 Advanced programming mode

Programming the advanced mode:

e.g. shutt off all additional functions except changing the temperature

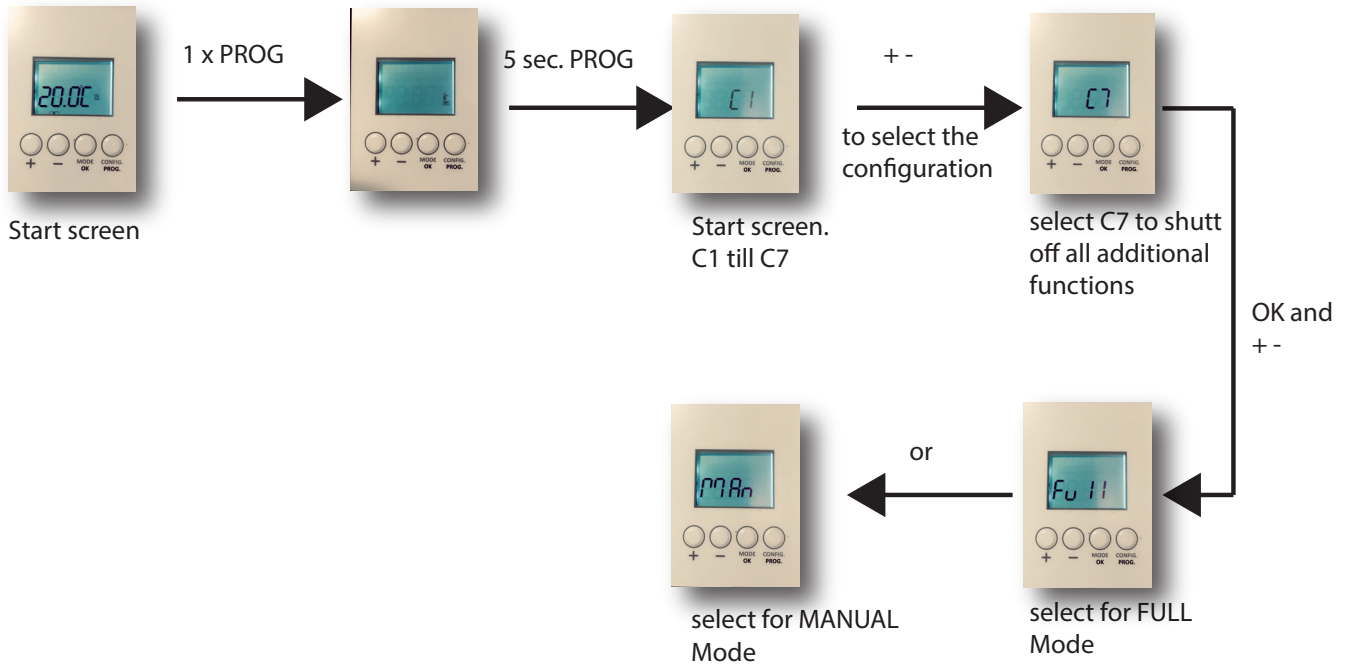

SCAN ME



This is a quick reference guide. More detailed information, videos and error messages can be found on the following website:

www.electric-smart-heater.com

You can also find many FAQ's on the above website.



SCAN ME